

QL Label Printing

Brother QL Label Printers have taken label printing to a new level. Whether you need one or many labels, they are fast, versatile and easy to print directly from your PC or Mac. Direct thermal printing eliminates the need for ink and toner.



The QL-1050 and QL-1060N are the two flagship models in Brother's range of professional label printers, offering the ultimate flexibility for all your labelling requirements.



By using continuous label rolls and the built-in cutter, any length of label can be printed, from 25mm up to 3m in length.

Overview of features	QL-1050	QL-1060N
Print labels from 12mm up to 102mm (1/2" to 4") in width	✓	✓
Built-in durable, automatic cutter	✓	✓
300dpi printing resolution	✓	✓
110mm/second print speed	✓	✓
Self-cleaning print-head	✓	✓
Includes advanced label design software in the box	✓	✓
Built-in fonts, barcodes and ESC/P emulation for maximum compatibility with legacy systems.	✓	✓
Integrated USB 1.1 and RS-232 ports	✓	✓
Single user support	✓	✓
Multiple user support	X	✓
Built-in 10/100 Base-TX Network interface	X	✓
Remote label printer management & configuration via web browser	X	✓

QL-1060N - Advanced networking as standard

The QL-1060N has the added advantage of a 10/100 Base TX-network port. This allows the printer to be located away from the PC, meaning it is easy to locate anywhere there is a network port in a building, so multiple users/computers can print to this single network printer. Alternatively, multiple QL-1060N label printers can be placed in various locations, and different print jobs sent to the required printer from the same computer.

The QL-1060N can be managed via any web browser on the network by connecting to the secure web server inside the label printer, enabling you to configure the network settings and other functions, and to also check the current status of the printer, such as if you have reached the end-of-roll, if the cover is open etc.

Choose your labels

STANDARD PAPER LABELS	Our paper labels have a special top coat applied, making them more durable than standard paper labels.
REMOVABLE PAPER LABELS	Easily removed from the item leaving no adhesive residue or other marks.
PLASTIC FILM LABELS	An excellent solution for temporary signage and when paper labels are not strong enough. Use the tear resistant plastic film labels in areas of occasional moisture and abrasion. Available in white, yellow and clear.



Pre-sized paper labels

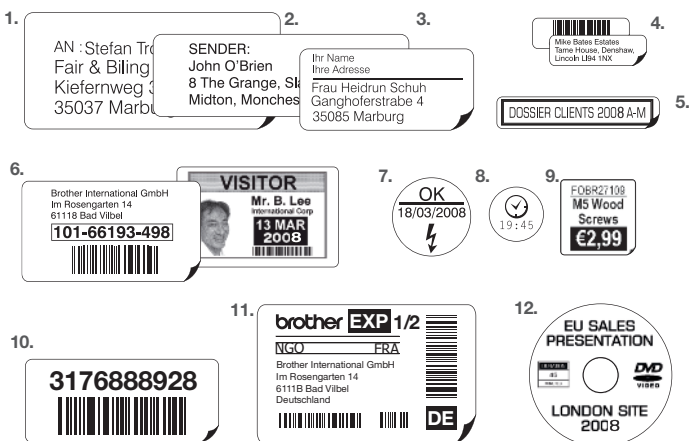

Pre-sized Labels

1 DK-11208	400/Roll 38mm x 90mm	8 DK-11219	1200/Roll ø 12mm
2 DK-11201	400/Roll 29mm x 90mm	9 DK-11240	600/Roll 102mm x 51mm*
3 DK-11209	800/Roll 29mm x 62mm	10 DK-11241	200/Roll 102mm x 152mm*
4 DK-11204	400/Roll 17mm x 54mm		
5 DK-11203	300/Roll 17mm x 87mm	FILM	
6 DK-11202	300/Roll 62mm x 100mm	11 DK-11207	100/Roll ø 58mm
7 DK-11218	1000/Roll ø 24mm		



Continuous label tape

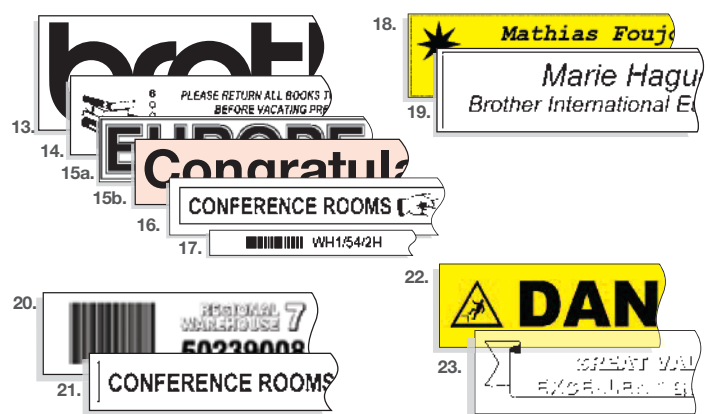

Continuous Label Tape

Paper		Film	
12 DK-22243	102mm x 30.48m*	16 DK-22212	62mm x 15.24m
13 DK-22205	62MM X 30.48m	17 DK-22606	62mm x 15.24m
14 DK-22210	29MM X 30.48m	18 DK-22113	62mm x 15.24m
15 DK-22214	12mm x 30.48m		

Ideal for use in:

- **Logistics and Warehousing**
- **Packaging Industry**
- **Hospitality & Events Management**
- **Medical & Healthcare sectors**
- **Manufacturing plants**
- **Production Facilities**
- **Offices**

Perfect labels, every time

Our professional 102mm wide label printers have been designed to give maximum flexibility and labelling options, whatever the labelling requirement. USB and RS-232 serial ports come as standard to ensure that the machines can connect to most equipment, while the QL-1060N additionally offers a built-in network port with advanced web based management features.

And because the label rolls are designed exclusively to work with the Brother range of QL label printers, you are assured of the highest quality printing. All the rolls are supplied on a special roll guide, which ensures that the labels are installed correctly, making it impossible to load the labels upside down. The guide also ensures that each label is printed straight, whatever size of label you produce.

Label creation software

The Brother b-PAC Software Development Kit (SDK) is a label printing COM object library, and allows software engineers to integrate the Brother range of label printers within Windows® applications easily and efficiently, and is available free-of-charge from Brother. The following diagram illustrates how you can use the b-PAC SDK to create a name label.

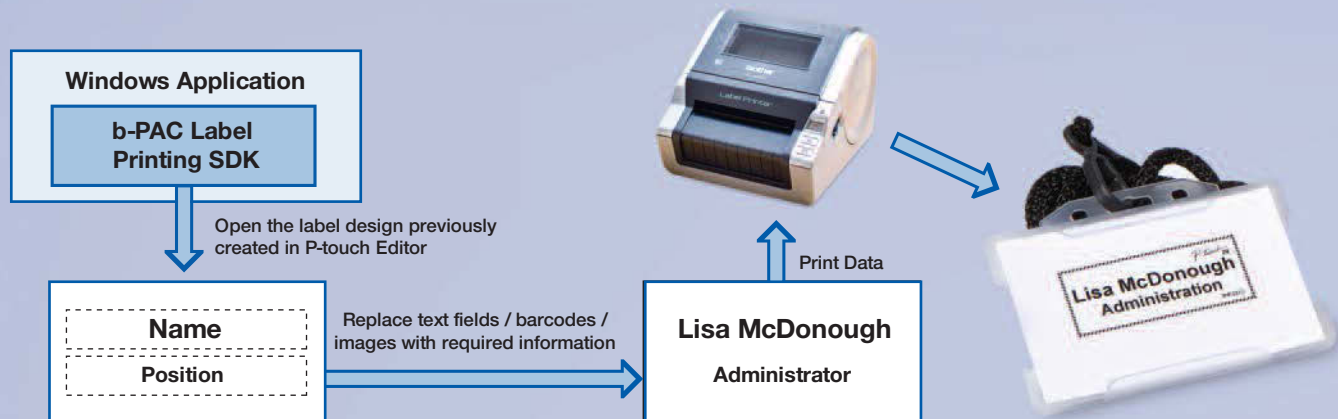

Label creation software

Brother supplies its label printing software in the box, at no additional cost. Three programs are included as standard, allowing you to choose the best program for your particular labelling application.

- A simple "Highlight, click and print" Add-In for popular Microsoft Office applications.
- Address Book program for storing addresses and printing shipping/postage labels.
- P-touch Editor is an advanced label design program specifically developed by Brother for its range of label printers. Many options are available, and the label you design will print out exactly the same as it appears on screen.

Some of the main features of P-Touch Editor include:

BARCODES - All popular industry standard barcode protocols, including 2D barcodes are supported.

DATABASE CONNECTION - connect to data held in Microsoft Excel, Access or CSV files and print this data onto your labels one after another.

CLIP ART/SYMBOLS - Hundreds of clip-art images are included.

GRAPHIC IMAGE IMPORT - Support for jpg, bmp, tif and png files, enabling you to include your company logo or specialist symbols on your labels.

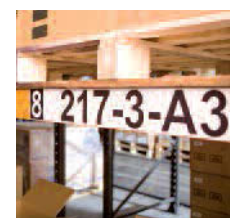
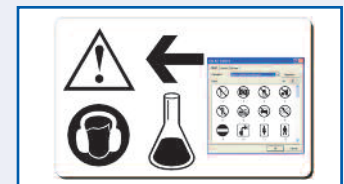

QL-1050 & QL-1060

Professional Label Printers

Specification	
Printer Requirements	Internal power supply - 220-240V AC
Printer Dimensions	171mm(W) x 224mm(D) x 148mm(H)
Print Head	Direct thermal 300x300 dpi
Maximum Print Speed**	110mm/second - 69 labels/minute
Maximum Label Width	102mm
Maximum Print Height	98.6mm
Maximum Label Length	3 metre
Automatic Cutter	Built-in permanent cutter
Interface	USB 1.1 or later specification RS-232 9-pin D-Sub
Network (QL-1060N only)	(10/100 Base-TX wired ethernet)



QL-1050 and QL-1060N Highlights

Quick and effective - print up to 69 labels per minute*

High quality - with 300 x 300dpi resolution print

Versatile - prints labels from 12mm to 102mm wide

Professional - with a built-in, heavy-duty automatic cutter

Easy to operate - print directly from MS Word, Excel or Outlook

Industrial - supports and prints most 1D and 2D barcode types

Flexible - network-ready, perfect for sharing and printing away from the PC (QL-1060 only)

Value for money with:

Free - sophisticated label design software

Free - 40 x DK Large Shipping Labels (102mm x 152mm)

Free - 8m DK Continuous label roll (62mm wide)

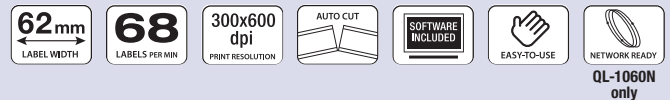

* Based on standard address labels

System Requirements PC		System Requirements Mac	
Operating Systems**	Microsoft Windows® 7 / Windows® 8 / Windows® 10	Operating Systems**	Mac OS X 10.3.9 to 10.11.4
Minimum CPU Speed	As recommended by operating system specifications	CPU	PowerPC or Intel
Minimum Memory (RAM)	As recommended by operating system specifications	Minimum Memory (RAM)	As recommended by operating system specifications
Hard Disk Free Space	70MB or more	Hard Disk Free Space	100MB or more
Interface(s)	As per individual mode specifications (above)	Interface(s)	As per individual mode specifications (above) - excluding RS-232
Graphics Card	SVGA with minimum 16 bit colour depth	Graphics Card	More than 256 colours
Other	CD-ROM drive for installation	Other	CD-ROM drive for installation

* Based on standard address labels ** For latest operating system support information visit <http://solutions.brother.com>



brother
at your side

Brother International South Africa

96 Sovereign Drive, Route 21 Corporate Park, Irene
Tel: +27 (0) 12 - 345 5332 Fax: +27 (0) 12 - 345 3886

www.brother.co.za <http://solutions.brother.com>



Working with you for a better environment
www.brotherearth.com

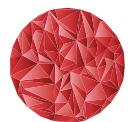

Japanese Excellence
For Over 100 Years